

# 产品目录

## Product Catalog

## 公司简介 Company Profile

青岛佰通工具制造有限公司成立于2012年10月25日，是一家专注于五金工具、管道设备及金属制品研发、生产与销售的专业制造企业。公司主营业务涵盖五金工具及配件、管道疏通设备及零配件、金属制品、塑料制品、铸铁管件及零配件等产品的加工、制造与销售，致力于为工业、建筑及民用领域提供高品质的配套产品解决方案。

凭借多年的技术积累与市场深耕，佰通工具制造以严谨的生产管理、创新的工艺技术和稳定的产品质量赢得客户信赖。公司严格遵循行业标准，坚持合规经营，所有业务均依法开展，并持续优化服务体系，满足国内外的多元化需求。未来，佰通工具制造将继续秉持精益求精的工匠精神，推动产品升级与产业创新，为客户创造更大价值。

Paragon Manufacturing Co.,Ltd. was established on October 25, 2012. It is a professional manufacturing enterprise focusing on the research and development, production and sales of hardware tools, pipeline equipment and metal products. The company's main business covers the processing, manufacturing and sales of hardware tools and accessories, pipeline dredging equipment and spare parts, metal products, plastic products, cast iron pipe fittings and spare parts, etc., and is committed to providing high-quality supporting product solutions for industrial, construction and civil fields.

With years of technical accumulation and market cultivation, Paragon Manufacturing has won the trust of customers with rigorous production management, innovative process technology and stable product quality. The company strictly follows industry standards and insists on compliant operations. All businesses are carried out in accordance with the law, and the service system is continuously optimized to meet the diversified needs of domestic and foreign markets.

In the future, Paragon Manufacturing will continue to uphold the spirit of craftsmanship of excellence, promote product upgrades and industrial innovation, and create greater value for customers.



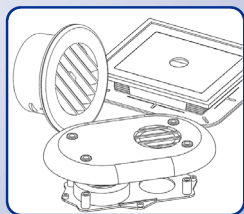

## 塑料制品 P<sub>01-04</sub>

Plastic Products

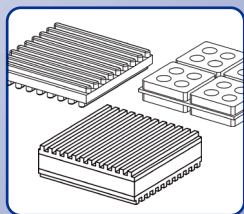

## 橡胶制品 P<sub>05-06</sub>

Rubber Products

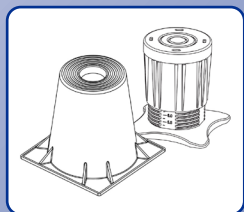

## 空调安装配件 P<sub>07-08</sub>

AC Installation Accessories



## 管道安装配件 P<sub>09-12</sub>

Pipe Installation Accessories

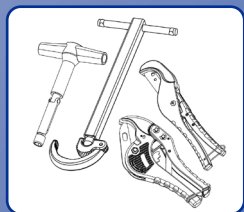

## 工具 P<sub>13-15</sub>

Tool

## 一体式设备(空调外机)脚 One-piece Equipment Stand

- 采用丁基密封胶上下包覆，防滑抗震，降低噪音。
- 有效延长冷凝器、热泵及空调机组的使用寿命。
- 提供适当离地高度，防止因积水导致设备受损。
- Encapsulated with butyl sealant to enhance slip resistance, vibration isolation, and noise reduction.
- Effectively extends the service life of condensers, heat pumps, and air conditioning units.
- Elevates equipment off the ground to prevent damage from standing water.

编号 Item No.	描述 Specifications	A	B	C	D
BT1003	3", 灰色 Gray	3.0"	6-1/4"	3-7/8"	3/32"
BT1006	6", 灰色 Gray	6.0"	6-1/4"	3-7/8"	3/32"
BT1012	12", 灰色 Gray	12.0"	6-1/4"	4-1/4"	9/64"

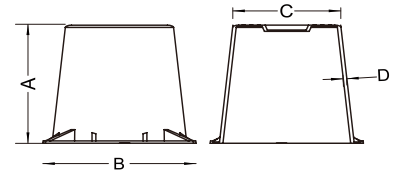
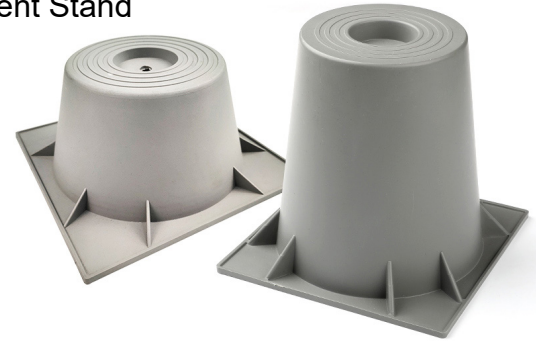

## 可调式设备(空调外机)脚 Adjustable Equipment Stand

- 结构稳固可靠。
- 独立上盖设计，可在设备就位后灵活升降调节。
- 方便调整设备高度，有效防止雨水积雪侵害。
- 带有高度刻度，调节时更加直观便捷。
- Stable and reliable.
- The independent top cover design allows flexible lifting and adjustment after the equipment is positioned.
- Facilitates leveling of equipment and provides protection against rain and snow accumulation.
- Height markings for precise and intuitive adjustments.

编号 Item No.	描述 Specifications
BT1067G	6"-7 1/4", 灰色 Gray
BT1067B	6"-7 1/4", 黑色 Black



## 壁挂式安装底座 Wall Mounting Block

- 适用于户外插座、水龙头、灯具、邮箱、门牌等安装。
- 采用耐候性PP材质，防碎裂、防开裂，持久耐用。
- 快速卡扣式设计，安装便捷，省时省力。
- 面板尺寸为8-3/16" × 7-3/16"，预留4英寸圆孔和2-3/8" × 3-3/4"矩形孔位。
- Suitable for outdoor outlets, faucets, light fixtures, mailboxes, and address plates.
- Made from high-durability polypropylene to resist cracking and breaking.
- Quick snap-in design for fast and effortless installation.
- Panel size: 8-3/16" × 7-3/16", pre-cut with a 4" round hole and a 2-3/8" × 3-3/4" rectangular opening.

编号 Item No.	描述 Specifications
BT1010W	白色 White



## 圆形出风口 Soffit Vents

- 两件式卡扣设计，安装隐藏螺丝更美观。
  - 百叶可旋转，内部配有防虫网。
  - 面板可拆卸，方便清洁维护。
  - 符合UL94-V阻燃标准，表面涂层阻燃防火。
  - 适用于墙面或天花板排风系统。
- Two-piece snap-in design hides mounting screws for a cleaner appearance.
  - Adjustable louvers with built-in insect screens.
  - Removable panel for easy cleaning and maintenance.
  - Complies with UL94-V flammability standards; flame-retardant surface coating.
  - Suitable for wall or ceiling exhaust systems.

编号 Item No.	描述 Specifications
BT2004W	4", 白色 White
BT2004B	4", 棕色 Brown

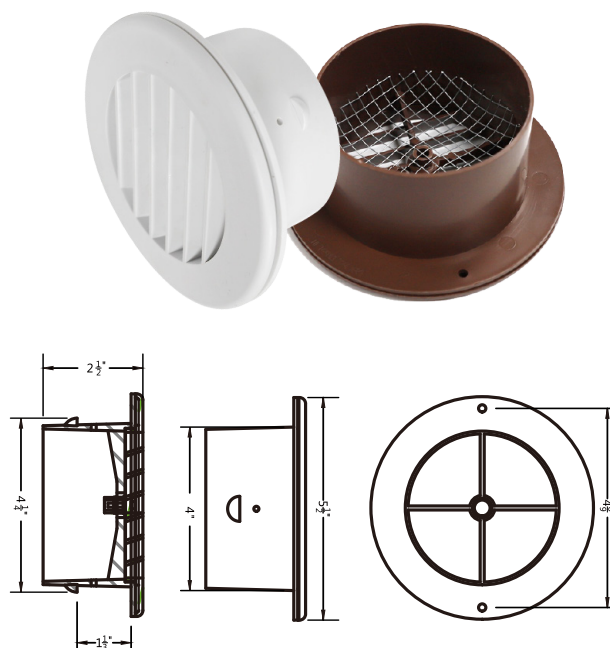

## 热水器空气循环面板 Horizontal Vent Kit

- 热水器水平排气专用套件。
  - 材质为加厚型PVC，耐腐蚀、不导电。
  - 可有效隐藏排气及进气管道，避免气流干扰。
- Specially designed for horizontal venting of water heaters.
  - Made of thickened PVC material for corrosion resistance and non-conductivity.
  - Effectively conceals exhaust and intake pipes, minimizing airflow interference.

编号 Item No.	描述 Specifications	A	B	C	D	E	F	G
BT2002	2"	7.2"	3.22"	NOM. 2"	NOM. 2"	11.2"	7.86"	2.46"
BT2003	3"	7.2"	3.22"	NOM. 3"	NOM. 3"	11.2"	7.86"	2.46"

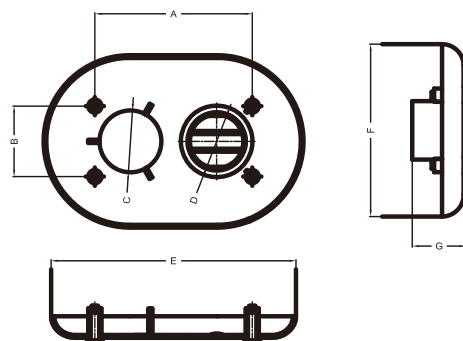



## 快速箍管扣 Plastic Pipe Clips



- 可开合的设计（弹性卡扣型）。
- 基座部分可以直接钉到墙上、板材或其他平面。
- 用于固定各种管道，比如：水管、冷媒管、电缆管线等。
- 不同大小（1/2"、3/4"、1" 等），适配不同直径的管子。
- Flexible snap-in design for quick and secure installation.
- Mounting base can be directly attached to walls, panels, or other surfaces.
- Ideal for securing water pipes, refrigerant lines, and electrical cables.
- Available in multiple sizes (1/2", 3/4", 1") to fit various pipe diameters.

编号 Item No.	描述 Specifications
BT3028	1/2"和5/8"PEX的锁夹 Lock Clip For 1/2" & 5/8" PEX
BT3034	3/4"PEX的锁夹 Lock Clip For 3/4" PEX
BT3010	1"PEX的锁夹 Lock Clip For 1" PEX

## 塑料管道固定夹 Plastic Pipe Clamp



- 适用于电线、电缆或管道固定。
- 材质坚固，安装快速，耐用性强。
- Designed for securing electrical wires, cables, or piping.
- Durable material ensures quick installation and long service life.

编号 Item No.	描述 Specifications
BT3512	1/2", 悬挂管夹 1/2", Suspension
BT3534	3/4", 悬挂管夹 3/4", Suspension
BT3501	1", 悬挂管夹 1", Suspension
BT3612	1/2", 标准管夹 1/2", Standard
BT3634	3/4", 标准管夹 3/4", Standard
BT3601	1", 标准管夹 1", Standard

## 带钉管卡 Plastic Insulated Pipe Clip with Nail

- 黑色HDPE。
- 带预装钉子。
- 开口式/闭口式两种款式。
- 用于快速固定管道，比如空调冷媒管、水管、电缆等。
- Made from high-quality, impact-resistant Black HDPE for long-lasting performance.
- Features a pre-mounted steel nail for fast attachment to walls, wood, or masonry surfaces.
- Designed to firmly hold water pipes, HVAC tubing, electrical conduits, and more.
- Simplifies installation.

编号 Item No.	描述 Specifications
BT3038	3/8" Pex
BT3012	1/2" Pex
BT3034	3/4" Pex
BT3100	1" Pex
BT31234	适用于 1/2"-3/4" Pex For 1/2" through 3/4" Pex
BT3212	1/2"全管爪 1/2" Full Tube Talon
BT3234	3/4"全管爪 3/4" Full Tube Talon



BT3038  
BT3021  
BT3034  
BT3100

BT31234

BT3212  
BT3234

## 地暖管塑料支架 Tubing Bend Support

- 支持标准90°角弯曲，结构牢固，安装简易。
- Supports standard 90° bends with a sturdy structure for easy and secure installation.

编号 Item No.	描述 Specifications
BT3338	3/8"
BT3312	1/2"
BT3334	3/4"
BT3412	1/2",垂耳式 Drop Ear



## 塑料管道吊架 Plastic Pipe Hanger

- 高强度塑料材质，替代传统镀锌带，防腐性能优异。
- 配有1/2英寸间距刻度标记，长度可选24"或48"。
- 棘轮式拉紧设计，安装更牢靠。
- 八角杆设计，便于角度安装分支管道，适用于DWV系统。
- Made from high-strength plastic to replace traditional galvanized strapping with excellent corrosion resistance.
- Features 1/2" spaced markings, available in 24" or 48" lengths.
- Ratchet tightening design ensures secure installation.
- Octagonal rod design facilitates branch pipe installations in DWV systems.

编号 Item No.	描述 Specifications
BT2024	塑料管道吊架套件, 24"杆 Plastic Pipe Hanger, 24" Rod
BT2048	塑料管道吊架套件, 48"杆 Plastic Pipe Hanger, 48" Rod
BT2020	塑料管道吊架扎带 Zip Ties for Plastic Pipe Hanger

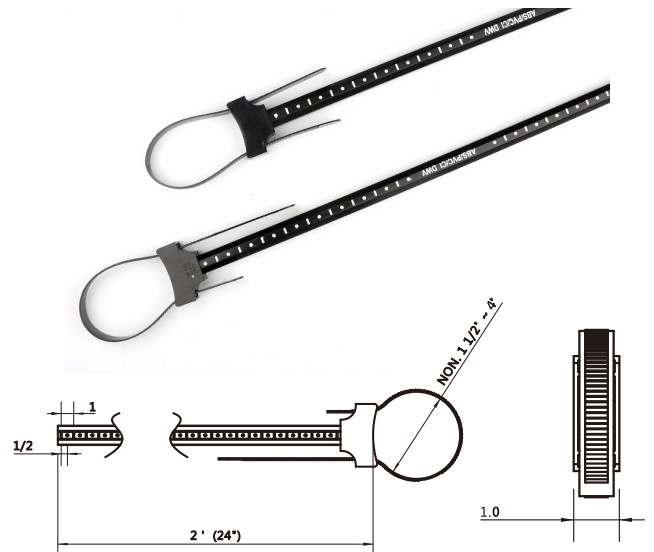

## PP织带 Polypropylene Webbing

- 适用于悬挂风管及其他用途。
- 高强度织带，质地均匀，耐磨耐用。
- 安装便捷，适合户外使用。
- 颜色可定制。
- Suitable for duct suspension and other applications.
- High-strength woven material with uniform texture for superior wear resistance.
- Easy to install and ideal for outdoor use.
- Colors can be customized.

编号 Item No.	描述 Specifications
BT37134B	1 3/4", 黑色 Black
BT37300B	3", 黑色 Black
BT37134S	1 3/4", 银色 Silver
BT37100S	3", 银色 Silver



## EVA复合橡胶垫 Rubber-EVA Anti-Vibration Pad

- 由高强度橡胶与EVA材质复合制成，结构更稳固，减震效果优于实心橡胶。
  - 不受油污和化学品侵蚀，耐老化、耐冲击。
  - 适用于热泵、音响、跑步机、洗衣机、空压机等设备的减震隔振。
  - 表面采用防滑设计，抗拉强度和延展性优异，承重力可达50 PSI可室内外使用。
  - 提供4种EVA层颜色选择。
- Constructed from a composite of high-strength rubber and EVA for superior stability and shock absorption compared to solid rubber.
  - Resistant to oil, chemicals, aging, and impact.
  - Ideal for use with heat pumps, speakers, treadmills, washing machines, and air compressors.
  - Anti-slip surface design with excellent tensile strength and elongation; supports up to 50 PSI for both indoor and outdoor use.
  - Provide 4 EVA layer color options.

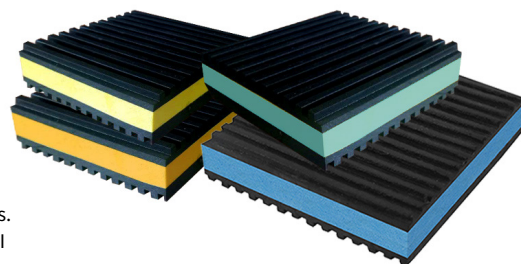

编号 Item No.	描述 Specifications
BT2278	2" x 2" x 7/8"
BT3378	3" x 3" x 7/8"
BT4478	4" x 4" x 7/8"
BT6678	6" x 6" x 7/8"
BT1878	18" x 18" x 7/8"

## 直条纹橡胶垫 Rubber Ribbed Pad

- 高品质弹性材料制成，耐老化、耐油、耐压缩。
  - 实心筋条结构，增强抓地力与隔振性能。
  - 推荐最大载荷为50磅/平方英寸。
- Made from high-quality elastic rubber for aging, oil, and compression resistance.
  - Solid ribbed structure enhances ground grip and vibration isolation.
  - Recommended maximum load capacity: 50 PSI.



编号 Item No.	描述 Specifications
BT2278A	2" x 2" x 7/8"
BT3378A	3" x 3" x 7/8"
BT4478A	4" x 4" x 7/8"
BT6678A	6" x 6" x 7/8"
BT1878A	18" x 18" x 7/8"



## 软木复合橡胶垫 Rubber-Cork Anti-Vibration Pad

- 由高强度橡胶与软木材质复合制成，具有更好隔振效果。
- 不受油污和化学品侵蚀，耐老化、耐冲击。
- 仅供干燥室内使用。
- Made of high-strength rubber and cork, it has better vibration isolation effect.
- Resistant to oil, chemicals, aging, and impact.
- For use in dry rooms only.

编号 Item No.	描述 Specifications
BT2278C	2" x 2" x 7/8"
BT3378C	3" x 3" x 7/8"
BT4478C	4" x 4" x 7/8"
BT6678C	6" x 6" x 7/8"
BT1278C	12" x 12" x 7/8"
BT1878C	18" x 18" x 7/8"

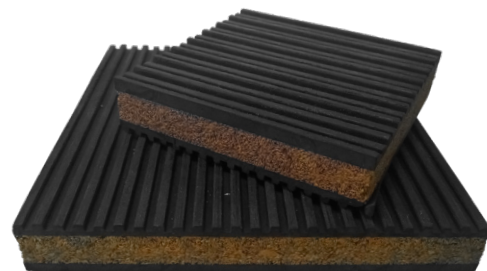

## 华夫格防震橡胶垫 Waffle Anti Vibration Rubber Pads

- 采用耐油耐化学腐蚀的全橡胶结构。
- 减震效果卓越，耐用性强。
- 适用于工业降噪隔振，可根据需要裁剪成型。
- Constructed from full rubber with excellent oil and chemical resistance.
- Exceptional vibration absorption and durability.
- Suitable for industrial noise and vibration reduction. Easily cut to desired shapes and sizes.

编号 Item No.	描述 Specifications	L	H	重量 Weight
BT2278W	2" x 2" x 7/8"	2"	3/4"	0.1 lbs
BT4478W	4" x 4" x 7/8"	4"	3/4"	0.41 lbs
BT1878W	18" x 18" x 7/8"	18"	3/4"	8.17 lbs

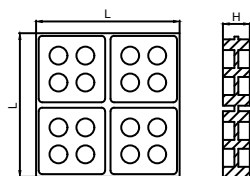

## 一体式设备(空调外机)脚 One-piece Equipment Stand

- 采用丁基密封胶上下包覆，防滑抗震，降低噪音。
- 有效延长冷凝器、热泵及空调机组的使用寿命。
- 提供适当离地高度，防止因积水导致设备受损。
- Encapsulated with butyl sealant to enhance slip resistance, vibration isolation, and noise reduction.
- Effectively extends the service life of condensers, heat pumps, and air conditioning units.
- Elevates equipment off the ground to prevent damage from standing water.

编号 Item No.	描述 Specifications	A	B	C	D
BT1003	3", 灰色 Gray	3.0"	6-1/4"	3-7/8"	3/32"
BT1006	6", 灰色 Gray	6.0"	6-1/4"	3-7/8"	3/32"
BT1012	12", 灰色 Gray	12.0"	6-1/4"	4-1/4"	9/64"

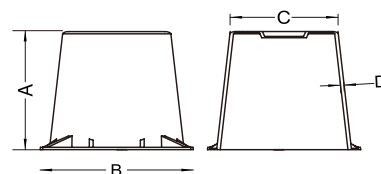
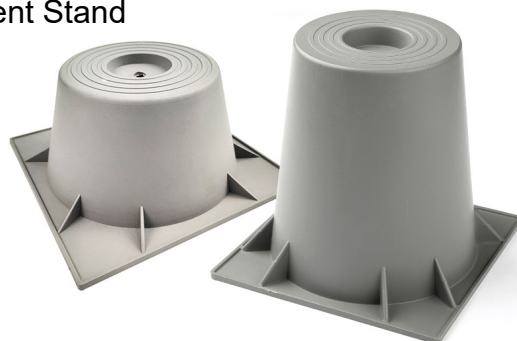

## 可调式设备(空调外机)脚 Adjustable Equipment Stand

- 结构稳固可靠。
- 独立上盖设计，可在设备就位后灵活升降调节。
- 方便调整设备高度，有效防止雨水积雪侵害。
- 带有高度刻度，调节时更加直观便捷。
- Stable and reliable.
- The independent top cover design allows flexible lifting and adjustment after the equipment is positioned.
- Facilitates leveling of equipment and provides protection against rain and snow accumulation.
- Height markings for precise and intuitive adjustments.

编号 Item No.	描述 Specifications
BT1067G	6"-7 1/4", 灰色 Gray
BT1067B	6"-7 1/4", 黑色 Black



## 快速箍管扣 Plastic Pipe Clips

- 可开合的设计（弹性卡扣型）。
- 基座部分可以直接钉到墙上、板材或其他平面。
- 用于固定各种管道，比如：水管、冷媒管、电缆管线等。
- 不同大小（1/2"、3/4"、1" 等），适配不同直径的管子。
- Flexible snap-in design for quick and secure installation.
- Mounting base can be directly attached to walls, panels, or other surfaces.
- Ideal for securing water pipes, refrigerant lines, and electrical cables.
- Available in multiple sizes (1/2", 3/4", 1") to fit various pipe diameters.



编号 Item No.	描述 Specifications
BT3028	1/2"和5/8"PEX的锁夹 Lock Clip For 1/2" & 5/8" PEX
BT3034	3/4"PEX的锁夹 Lock Clip For 3/4" PEX
BT3010	1"PEX的锁夹 Lock Clip For 1" PEX

## EVA复合橡胶垫 Rubber-EVA Anti-Vibration Pad

- 由高强度橡胶与EVA材质复合制成，结构更稳固，减震效果优于实心橡胶。
- 不受油污和化学品侵蚀，耐老化、耐冲击。
- 适用于热泵、音响、跑步机、洗衣机、空压机等设备的减震隔振。
- 表面采用防滑设计，抗拉强度和延展性优异，承重力可达50 PSI 可室内外使用。
- 提供4种EVA层颜色选择。
- Constructed from a composite of high-strength rubber and EVA for superior stability and shock absorption compared to solid rubber.
- Resistant to oil, chemicals, aging, and impact.
- Ideal for use with heat pumps, speakers, treadmills, washing machines, and air compressors.
- Anti-slip surface design with excellent tensile strength and elongation; supports up to 50 PSI for both indoor and outdoor use.
- Provide 4 EVA layer color options.

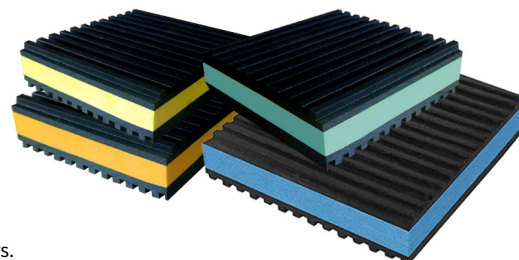

编号 Item No.	描述 Specifications
BT2278	2" x 2" x 7/8"
BT3378	3" x 3" x 7/8"
BT4478	4" x 4" x 7/8"
BT6678	6" x 6" x 7/8"
BT1878	18" x 18" x 7/8"

## 铸铁底座压力表 Bell Body Test Gauge for Gas Line

- 仪表盘清晰易读，表盘直径为2英寸。
- 结构坚固耐用，性能可靠。
- 黑色铁制螺纹连接，密封性好。
- 易于安装。
- Easy-to-read gauge with clear facing, gauges are 2" diameter face.
- Durable construction for performance reliability.
- Black iron threaded bell for leak tight connection.
- Easy to install.



编号 Item No.	描述 Specifications	A	B	C	D Connector
BT1215	1/2" 0-15 PSI	1.2"	1.4"	2"	1/16" NPT
BT3415	3/4" 0-15 PSI	1.5"	1.5"	2"	1/16" NPT
BT1015	1" 0-15 PSI	1.8"	1.7"	2"	1/16" NPT
BT1230	1/2" 0-30 PSI	1.2"	1.4"	2"	1/16" NPT
BT3430	3/4" 0-30 PSI	1.5"	1.5"	2"	1/16" NPT
BT1030	1" 0-30 PSI	1.8"	1.7"	2"	1/16" NPT
BT1260	1/2" 0-60 PSI	1.2"	1.4"	2"	1/16" NPT
BT3460	3/4" 0-60 PSI	1.5"	1.5"	2"	1/16" NPT
BT1060	1" 0-60 PSI	1.8"	1.7"	2"	1/16" NPT
BT12100	1/2" 0-100 PSI	1.2"	1.4"	2"	1/16" NPT
BT34100	3/4" 0-100 PSI	1.5"	1.5"	2"	1/16" NPT
BT10100	1" 0-100 PSI	1.8"	1.7"	2"	1/16" NPT

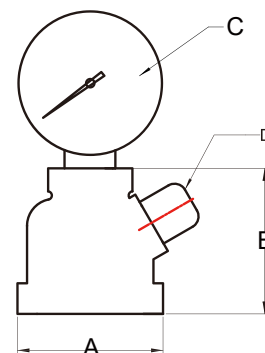

## 平行安装压力表 Parallel Hex Fitting for Pressure Gauge

- 仪表清晰易读，刻度精准。
- 测试气压，安装简便，使用方便。
- 结构坚固耐用，性能可靠。
- 彩色镀锌铁制螺纹喇叭口，密封连接。
- Easy-to-read gauge with clear facing, accurate scale.
- Test air pressure and easy to install and convenient to use.
- Durable construction for performance reliability
- Colored galvanized iron threaded bell for leak tight connection.



编号 Item No.	描述 Specifications	A	B	C	D Connector	E
BT1215H	1/2" 0-15 PSI	1/2" NPT	1.0"	0.9"	1/16" NPT	2"
BT3415H	3/4" 0-15 PSI	3/4" NPT	1.25"	1.1"	1/16" NPT	2"
BT1015H	1" 0-15 PSI	1" NPT	1.6"	1.4"	1/16" NPT	2"
BT1230H	1/2" 0-30 PSI	1/2" NPT	1.0"	0.9"	1/16" NPT	2"
BT3430H	3/4" 0-30 PSI	3/4" NPT	1.25"	1.1"	1/16" NPT	2"
BT1030H	1" 0-30 PSI	1" NPT	1.6"	1.4"	1/16" NPT	2"
BT1260H	1/2" 0-60 PSI	1/2" NPT	1.0"	0.9"	1/16" NPT	2"
BT3460H	3/4" 0-60 PSI	3/4" NPT	1.25"	1.1"	1/16" NPT	2"
BT1060H	1" 0-60 PSI	1" NPT	1.6"	1.4"	1/16" NPT	2"
BT12100H	1/2" 0-100 PSI	1/2" NPT	1.0"	0.9"	1/16" NPT	2"
BT34100H	3/4" 0-100 PSI	3/4" NPT	1.25"	1.1"	1/16" NPT	2"
BT10100H	1" 0-100 PSI	1" NPT	1.6"	1.4"	1/16" NPT	2"

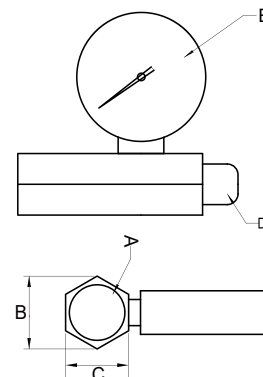

## 垂直安装压力表 Vertical Hex Fitting for Pressure Gauge

- 全系列配备2英寸直径表盘，清晰读数，坚固耐用。
- 镀锌螺纹接口，确保优良密封性，适合各种气压测试应用。
- All models feature a 2-inch diameter face for clear visibility and durability.
- Galvanized threaded connections ensure excellent sealing, ideal for various gas pressure testing applications.

编号 Item No.	描述 Specifications	A	B	C	D Connector	E
BT1215V	1/2" 0-15 PSI	1/2" NPT	1.0"	0.9"	1/16" NPT	2"
BT3415V	3/4" 0-15 PSI	3/4" NPT	1.25"	1.1"	1/16" NPT	2"
BT1015V	1" 0-15 PSI	1" NPT	1.6"	1.4"	1/16" NPT	2"
BT1230V	1/2" 0-30 PSI	1/2" NPT	1.0"	0.9"	1/16" NPT	2"
BT3430V	3/4" 0-30 PSI	3/4" NPT	1.25"	1.1"	1/16" NPT	2"
BT1030V	1" 0-30 PSI	1" NPT	1.6"	1.4"	1/16" NPT	2"
BT1260V	1/2" 0-60 PSI	1/2" NPT	1.0"	0.9"	1/16" NPT	2"
BT3460V	3/4" 0-60 PSI	3/4" NPT	1.25"	1.1"	1/16" NPT	2"
BT1060V	1" 0-60 PSI	1" NPT	1.6"	1.4"	1/16" NPT	2"
BT12100V	1/2" 0-100 PSI	1/2" NPT	1.0"	0.9"	1/16" NPT	2"
BT34100V	3/4" 0-100 PSI	3/4" NPT	1.25"	1.1"	1/16" NPT	2"
BT10100V	1" 0-100 PSI	1" NPT	1.6"	1.4"	1/16" NPT	2"

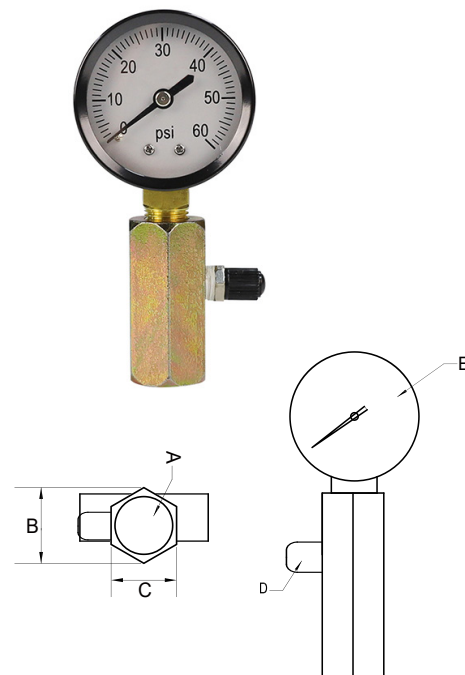

## 钢制管道吊架 Steel Pipe Hanger

- 专为ABS、PVC及DWV排水系统管道设计。
- 采用镀锌钢材制造，承载能力强，耐用耐腐蚀。
- 内衬羊毛毡，有效保护管材表面，安装快速简便。
- Designed for ABS, PVC, and DWV drainage systems.
- Made of galvanized steel for superior strength and corrosion resistance.
- Inner felt liner protects pipe surfaces. Quick and easy installation.

编号 Item No.	描述 Specifications	A	B	C	D	E	F
BT2112	1 1/2" x 14"	14"	1 1/2"	1/4"	3/16"	13/16"	1"
BT2200	2" x 14"	14"	2"	1/4"	3/16"	13/16"	1"
BT2300	3" x 14"	14"	3"	1/4"	3/16"	13/16"	1"
BT2400	4" x 14"	14"	4"	1/4"	3/16"	13/16"	1"

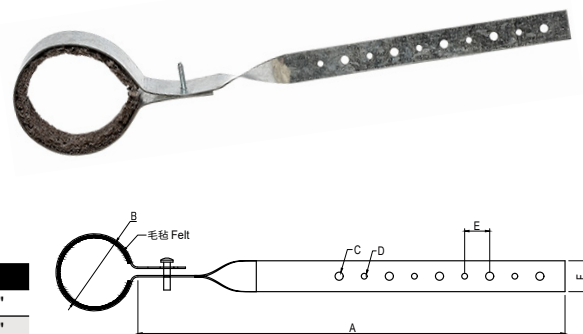

## 带孔金属带 Galvanized Steel Strap

- 镀锌钢制成，适用于吊挂柔性风管。
- 易钻易钉，配备纸箱分装，使用方便，坚固耐用。
- Made of galvanized steel for hanging flexible ductwork.
- Easy to drill and nail; packaged for convenient use, sturdy and durable.

编号 Item No.	描述 Specifications
BT3710	3/4" x 10' 28GA
BT3750	3/4" x 50' 28GA
BT37100	3/4" x 100' 28GA





## 快速箍管扣 Plastic Pipe Clips



- 可开合的设计（弹性卡扣型）。
- 基座部分可以直接钉到墙上、板材或其他平面。
- 用于固定各种管道，比如：水管、冷媒管、电缆管线等。
- 不同大小（1/2"、3/4"、1" 等），适配不同直径的管子。
- Flexible snap-in design for quick and secure installation.
- Mounting base can be directly attached to walls, panels, or other surfaces.
- Ideal for securing water pipes, refrigerant lines, and electrical cables.
- Available in multiple sizes (1/2", 3/4", 1") to fit various pipe diameters.

编号 Item No.	描述 Specifications
BT3028	1/2"和5/8"PEX的锁夹 Lock Clip For 1/2" & 5/8" PEX
BT3034	3/4"PEX的锁夹 Lock Clip For 3/4" PEX
BT3010	1"PEX的锁夹 Lock Clip For 1" PEX

## 塑料管道固定夹 Plastic Pipe Clamp



- 适用于电线、电缆或管道固定。
- 材质坚固，安装快速，耐用性强。
- Designed for securing electrical wires, cables, or piping.
- Durable material ensures quick installation and long service life.

编号 Item No.	描述 Specifications
BT3512	1/2", 悬挂管夹 1/2", Suspension
BT3534	3/4", 悬挂管夹 3/4", Suspension
BT3501	1", 悬挂管夹 1", Suspension
BT3612	1/2", 标准管夹 1/2", Standard
BT3634	3/4", 标准管夹 3/4", Standard
BT3601	1", 标准管夹 1", Standard

## 带钉管卡 Plastic Insulated Pipe Clip with Nail

- 黑色HDPE。
- 带预装钉子。
- 开口式/闭口式两种款式。
- 用于快速固定管道，比如空调冷媒管、水管、电缆等。
- Made from high-quality, impact-resistant Black HDPE for long-lasting performance.
- Features a pre-mounted steel nail for fast attachment to walls, wood, or masonry surfaces.
- Designed to firmly hold water pipes, HVAC tubing, electrical conduits, and more.
- Simplifies installation.

编号 Item No.	描述 Specifications
BT3038	3/8" Pex
BT3012	1/2" Pex
BT3034	3/4" Pex
BT3100	1" Pex
BT31234	适用于 1/2"-3/4" Pex For 1/2" through 3/4" Pex
BT3212	1/2"全管爪 1/2" Full Tube Talon
BT3234	3/4"全管爪 3/4" Full Tube Talon



BT3038  
BT3021  
BT3034  
BT3100

BT31234

BT3212  
BT3234

## 地暖管塑料支架 Tubing Bend Support

- 支持标准90°角弯曲，结构牢固，安装简易。
- Supports standard 90° bends with a sturdy structure for easy and secure installation.

编号 Item No.	描述 Specifications
BT3338	3/8"
BT3312	1/2"
BT3334	3/4"
BT3412	1/2",垂耳式 Drop Ear



## 塑料管道吊架 Plastic Pipe Hanger

- 高强度塑料材质，替代传统镀锌带，防腐性能优异。
- 配有1/2英寸间距刻度标记，长度可选24"或48"。
- 棘轮式拉紧设计，安装更牢靠。
- 八角杆设计，便于角度安装分支管道，适用于DWV系统。
- Made from high-strength plastic to replace traditional galvanized strapping with excellent corrosion resistance.
- Features 1/2" spaced markings, available in 24" or 48" lengths.
- Ratchet tightening design ensures secure installation.
- Octagonal rod design facilitates branch pipe installations in DWV systems.

编号 Item No.	描述 Specifications
BT2024	塑料管道吊架套件，24"杆 Plastic Pipe Hanger, 24" Rod
BT2048	塑料管道吊架套件，48"杆 Plastic Pipe Hanger, 48" Rod
BT2020	塑料管道吊架扎带 Zip Ties for Plastic Pipe Hanger

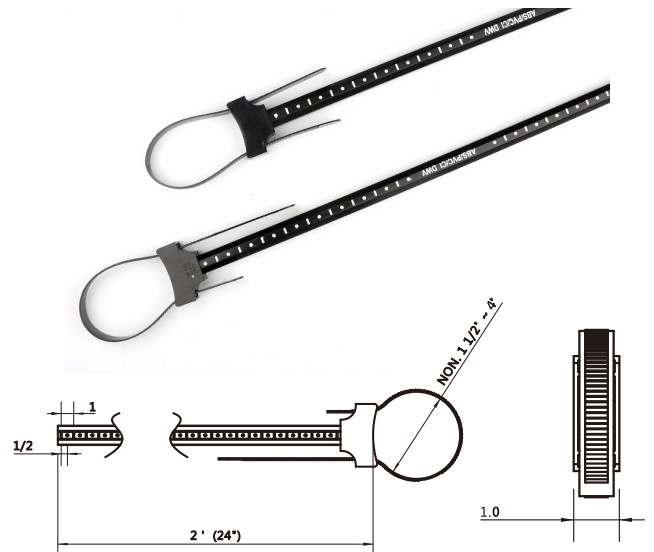

## PP织带 Polypropylene Webbing

- 适用于悬挂风管及其他用途。
- 高强度织带，质地均匀，耐磨耐用。
- 安装便捷，适合户外使用。
- 颜色可定制。
- Suitable for duct suspension and other applications.
- High-strength woven material with uniform texture for superior wear resistance.
- Easy to install and ideal for outdoor use.
- Colors can be customized.

编号 Item No.	描述 Specifications
BT37134B	1 3/4", 黑色 Black
BT37300B	3", 黑色 Black
BT37134S	1 3/4", 银色 Silver
BT37100S	3", 银色 Silver



## 棘轮割管器 Ratchet Pipe Cutter

- 棘轮式塑料管剪，适用于PVC、橡胶软管及塑料管材切割。
- 单手操作省力便捷，配有安全锁扣，存放更安全。
- 专业棘轮驱动，轻松剪切直径小于1-5/8英寸的管材。
- Durable pipe cutter for cutting PVC, plastic & rubber tubing.
- One-hand operation with a safety latch for secure storage.
- Professional ratchet mechanism for effortless cutting of pipes up to 1-5/8" in diameter.

编号 Item No.	描述 Specifications
BT4001	棘轮割管器 Ratchet Pipe Cutter
BT4001-B	刀片 Blade ONLY



## 软管割刀 Pipe Cutters

- 专业型软管剪刀，适用于各类管材切割。
- 采用高强度铝合金手柄，结实耐用。
- 配有锁定装置，安全收纳。
- 可切割直径达 2 英寸的软管。
- Designed for precise cutting of various hose materials.
- High-strength aluminum alloy handle for enhanced durability.
- Equipped with a locking mechanism for safe storage.
- Cuts up to 2" soft tubing.

编号 Item No.	描述 Specifications
BT4002	软管割刀 Pipe Cutters
BT4002-B	刀片 Blade ONLY



## 定值扭力套筒扳手 No Hub Torque Wrench

- 适用于拧紧或松开各种螺丝和螺母
- 整体采用T字型设计，手柄部分便于施力，操作舒适高效。
- 广泛应用于机械维修、汽车保养以及各类装配工作中，尤其适合空间受限但需要大扭矩操作的场合。
- Ideal for tightening or loosening various bolts and nuts.
- T-handle design provides greater torque and comfortable handling.
- Widely used in machinery repair, automotive maintenance, and assembly work, especially in tight spaces requiring high torque.

编号 Item No.	描述 Specifications
BT4003	60英寸磅扭矩，套筒尺寸5/16" Torque 60 in.-lbs., Socket Size 5/16"
BT4004	80英寸磅扭矩，套筒尺寸5/16" Torque 80 in.-lbs., Socket Size 5/16"
BT4005	80英寸磅扭矩，套筒尺寸3/8" Torque 80 in.-lbs., Socket Size 3/8"



## 台盆扳手 Basin Wrench

- 专为狭小空间下安装与拆卸水龙头或管件而设计，特别适用于水槽下方难以触及的位置。
- 扳手配备可调节旋转头部，能够牢固夹紧螺母和接头，长柄设计则提供了更大的延伸距离与更强的扭矩力。
- 整体采用高强度钢材制造，耐用且防锈，适应各种复杂施工环境。
- Specifically designed for installing and removing faucets and fittings in confined spaces, such as under sinks.
- Adjustable rotating head grips nuts and fittings securely, while the extended handle provides greater reach and torque.
- Constructed from high-strength steel for durability and corrosion resistance, suitable for complex installation environments.

编号 Item No.	描述 Specifications
BT4006	适用直径 0.39"至 1.25" fit 0.39" to 1.25" in diameter
BT4006-L	适用直径 1.25"至 2.5" fit 1.25" to 2.5" in diameter



## 马桶和小便池螺旋疏通器 Closet & Urinal Augers

- 专业水管工款式。
- 手柄上模压线缆固定夹。
- 回火弹簧钢。
- 乙烯基握把和碗状保护罩。

- Professional plumber style.
- Cable hold clip molded on handle.
- Tempered spring steel.
- Vinyl grips and bowl guard.

### 固定头 Regular Head

编号 Item No.	描述 Specifications
BT4007	长度3', 1-1/8"重型导管 Overall Length 3', 1-1/8" Heavy Duty Guide Tube
BT4007-L	长度6', 1-1/8"重型导管 Overall Length 6', 1-1/8" Heavy Duty Guide Tube



### 活动头 Drop Head

编号 Item No.	描述 Specifications
BT4008	长度3', 1-1/8"重型导管 Overall Length 3', 1-1/8" Heavy Duty Guide Tube
BT4008-L	长度6', 1-1/8"重型导管 Overall Length 6', 1-1/8" Heavy Duty Guide Tube

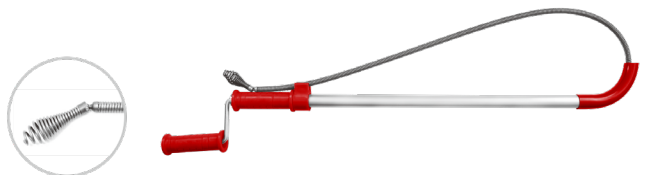

### 小便池-固定头 Urinal - Regular Head

编号 Item No.	描述 Specifications
BT4009	长度4', 1-1/8"重型导管 Overall Length 4', 1-1/8" Heavy Duty Guide Tube

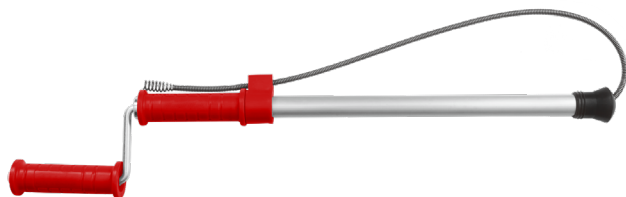





**青岛佰通工具制造有限公司**

地址：山东省青岛市黄岛区铁山工业园平湖路11号

电话：0532-84123538

传真：0532-84123528

**PARAGON MANUFACTURING CO.,LTD**

Add: 11 Pinghu Road, Tieshan Industrial Park, Huangdao District,  
Qingdao City, Shandong Province, China

Tel: 0532-84123538

Fax: 0532-84123528